

## OCHRE MACRAME WALL HANGER

**Design:** Lankava, Annikki Orrenmaa

**Finished size:** 40x75 cm

**Yarn:** 500g of Paulina Chunky Twine in Lion yellow (71) (80% recycled cotton, 20% polyester, 1kg = 180-190m).

**Other supplies:** A tree stick, a needle, and sewing thread in the color of the macrame twine.

**Lark's Head Knot = LHK (pic 1):** Fold a length in half. Take the fold around the stick from front to back, take the open ends through the loop, tighten the knot around the stick (= 2 working cords).

**Square Knot = SK (pic 2):** Use 4 cords to make the knot in 2 stages.

**Stage 1:** Take the left edge cord over the 2 middle cords and under the right edge cord, then take the right edge cord under the middle cords and over the left edge cord, through the loop. Tighten by pulling the cords in the opposite directions.

**Stage 2:** Take the right edge cord over the middle cords and under the left edge cord, then take the left edge cord under the middle cords and over the right edge cord, through the loop. Tighten. = 1 SK.

**Half Hitch Knot = HHK (pics 3-4):** Work 1 half hitch knot around a horizontal (diagonal) filler cord.

HHK from left to right (pic 3): Keep the filler cord

horizontally (diagonally) in front of the working cords with your right hand, take a working cord up and around the filler cord, then take it back down to the left of itself, tighten the knot around the filler cord.

HHK from right to left (pic 4): Keep the filler cord horizontally (diagonally) in front of the working cords with your left hand, take a working cord up and around the filler cord, then take it back down to the right of itself, tighten the knot around the filler cord.

**Double Half Hitch Knot = DHHK (pics 5-6):** Work 2 half hitch knots around a horizontal (diagonal) filler cord.

DHHK from left to right (pic 5): Keep the filler cord horizontally (diagonally) in front of the working cords with your right hand, \*take a working cord up and around the filler cord, then take it back down to the left of itself, tighten the knot around the filler cord\*, repeat \*-\* once more with the same working cord. Tighten the knots next to each other.

DHHK from right to left (pic 6): Keep the filler cord horizontally (diagonally) in front of the working cords with your left hand, \*take a working cord up and around the filler cord, then take it back down to the right of itself, tighten the knot around the filler cord\*, repeat \*-\* once more with the same working cord. Tighten the knots next to each other.

**Alternating Half Hitch Knot = AHHK (pic 7):** Use 2 cords to make the knot in 2 stages.

**Stage 1:** Take the left cord around the right cord from front to back, then back to front, over itself. Tighten.

**Stage 2:** Take the right cord around the left cord from front to back, then back to front, over itself. Tighten.

Note: When making diagonal DHHKs, keep the filler cord diagonal.

**Instructions:** The piece consists of three parts: the middle part, curved side parts, and fringes.

**Middle part:** Cut 14 lengths of 200cm, and one 60cm filler cord. Fold the lengths in half, except the filler, and attach them onto the stick using LHKs. Pin the filler cord of its middle into the middle of the working cords. Knot one end of the filler cord around the stick, left of the working cords. Remove the pin. Keep the filler cord horizontal and make 1 HHK, or DHHK, around it with each working cord = 28 HHKs or DHHKs. Tighten the knots immediately under the stick. Leave the filler cord and 4 cords at each edge waiting and work alternating SKs with the rest of the cords, as follows:

**Row 1:** \*Make 1 SK with 4 cords\*, repeat \*-\* 4 more times = 5 SKs.

**Row 2:** Make 4 alternating SKs between the SKs from previous row.

**Row 3:** Make 3 alternating SKs between the SKs from previous row.

**Row 4:** Make 2 alternating SKs between the SKs from previous row.

**Row 5:** Make 1 alternating SK between the SKs from previous row.

Next, take the filler cord waiting at the left back into the work, keep it diagonally underneath the SKs and make 14 HHKs or DHHKs around it, from left to right. In a mirror image, take the filler cord waiting at the right and make 14 HHKs or DHHKs around it, from right to left. Weave in the ends of the filler cords now meeting at the middle on the wrong side. Mark the 2 middle working cords for attaching the side parts later.

**Side parts:** Cut 10 lengths of 300cm. Attach 5 lengths using LHKs onto the stick, on both sides of the middle part. Begin with the right side part. Make the first cord from left a filler cord.



**Row 1:** Keep the filler cord horizontal and make 9 HHKs or DHHKs around it from left to right. Continue to work rows of DHHKs around the filler cord in a zigzag pattern (see picture).

**Row 2:** Keep the filler cord diagonal and make 9 HHKs or DHHKs around it from right to left.

**Row 3:** Keep the filler cord diagonal and make 9 HHKs or DHHKs around it from left to right.

Repeat rows 2-3 in total 4 times. Repeat the same knots for the left side part in a mirror image.

Leave the cords of the side parts waiting. Take the 2 cords marked at the end of the middle part and measure approx. 7cm below the HHKs or DHHKs, mark this spot. The side parts will be attached at this mark so that the side parts form arches around the middle part. Next, make 5 AHHKs downwards from the mark and sew the side parts by hand on both sides of the first knot (pic 8). Knot the filler cords of the side parts together but leave an approx. 1cm space on both sides before the knot, for attaching the fringes later. Move the cords of the upper AHHKs at the back of the work. Make 6 AHHKs with the filler cords that were knotted together.

**Fringes:** Cut 20 lengths of 115cm, and 2 lengths of 150cm. Attach these lengths using LHKs into the lowest arches of the curved side parts, to make fringes. Attach two shorter cords on both sides of the middle arch, 4 short cords onto the next arches outwards, then 1 longer and 3 shorter cords, and finally 1 short cord. Make 6 AHHKs with the longer cords. Cut fringes into desired length.

**Pic 1:** Lark's Head Knot = LHK

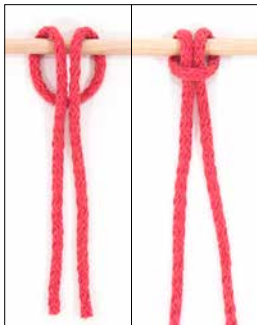

**Pic 2:** Square Knot = SK

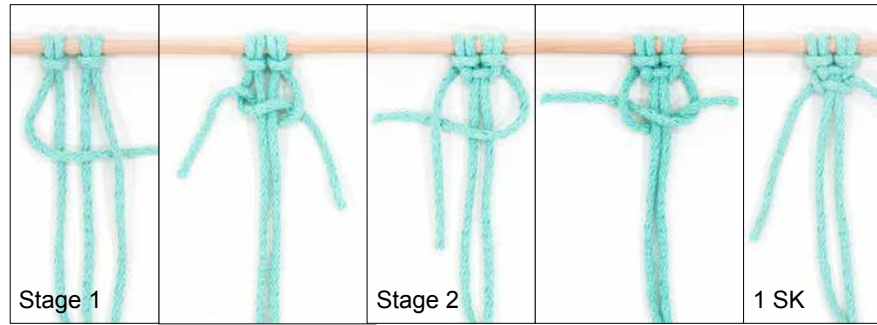

**Pic 3:** Half Hitch Knot = HHK from left to right

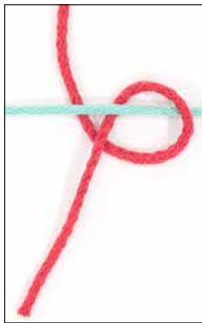

**Pic 4:** Half Hitch Knot = HHK from right to left

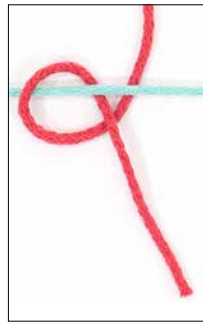

**Pic 5:** Double Half Hitch Knot = DHHK from left to right

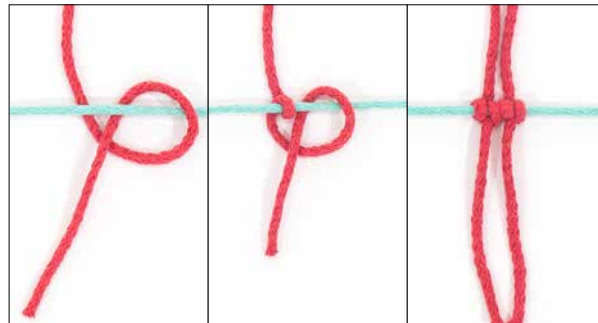

**Pic 6:** Double Half Hitch Knot = DHHK from right to left

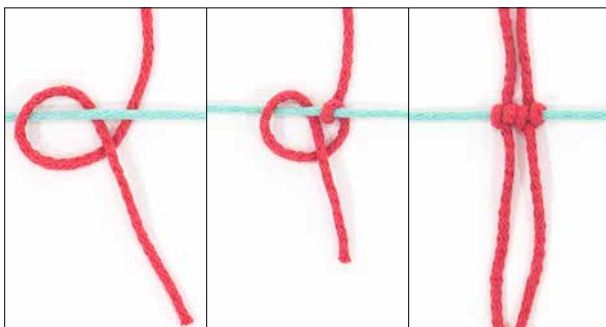

**Pic 7:** Alternating Half Hitch Knot = AHHK

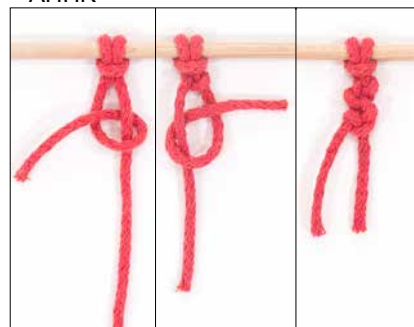

**Pic 8**



○ = Sew the side parts by hand on both sides of the first knot.

Any commercial use of this pattern is prohibited.